

How to Perform a Titration for Alkaline (Hi pH) Chemicals

Step One: Rinse the sample vial with the test solution.

Step Two: Fill the test tube to the **10 ml** mark with the solution to be tested.



Step Three: Add 3-5 drops of Indicator P (#014). Mix.

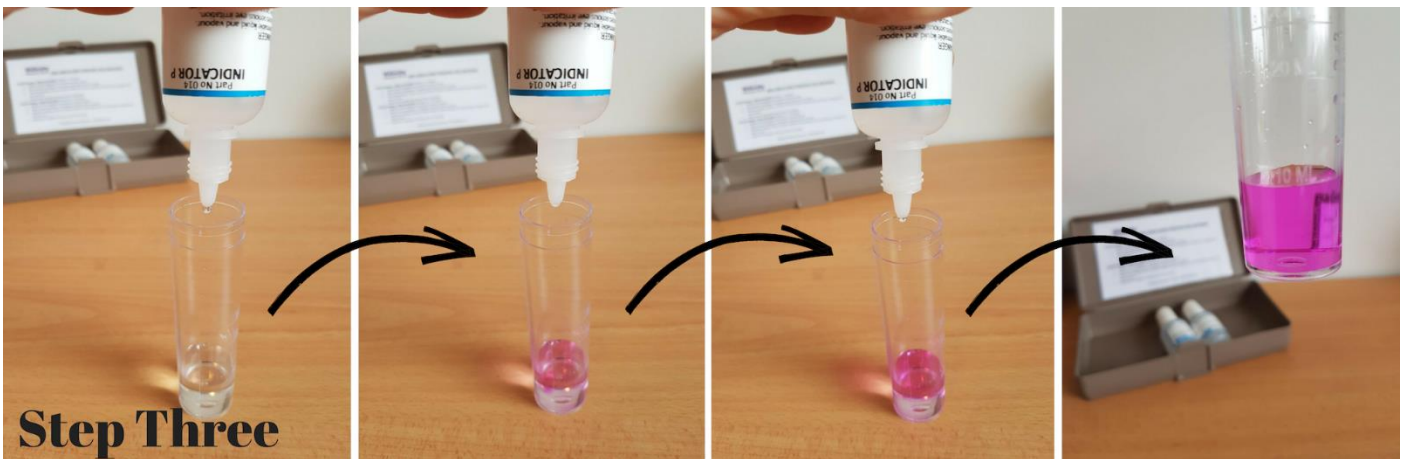

Continued next page

How to Perform a Titration for Alkaline (Hi pH) Chemicals

Step Four: Titrate with reagent 1.0N Hydrochloric Acid (#085) one drop at a time, counting and mixing between each drop until the solution changes from **pink to colourless**.



Step Five: Record number of drops.

Step Six: Consult Product Specification Sheet (PSR) to calculate product concentration. PSR's for all Velocity Vehicle Care products are available for download at www.velocityvehiclecare.com

<p>Zep VehicleCare Product Specification Report BLUE CORAL® AHS HI pH 3100 PAGE 1 OF 2</p> <p>CLASSIFICATION: • High pH/PreP/Wash/Chemical products</p> <p>PRODUCT DESCRIPTION: • Highly concentrated foaming alkaline liquid designed for toughest washing • Can be used for foaming alkaline prewash or prewash to heavy dirt/dust • Soft water is recommended for dilution water of AHS HI pH 3100 • Recommended to use in closed pressure wash systems with washers</p> <p>FEATURES & BENEFITS: • Free foaming • Aggressive cleanses asphalt, oil, road film, brake dust, oil, and grease • Safe driving • Environmentally safe</p> <p>PHYSICAL CHARACTERISTICS: • Form: Liquid • Color: Amber • Odor: Odorless • pH: 12.5 • Specific Gravity: 1.200 • Flammable per GHS: 0211 • Volatile per GHS: 0212 • Health Hazard: 0314 (skin corrosion) • Biodegradability: Complete biodegradability</p> <p>PACKAGE SIZES & PRODUCT NUMBERS</p> <table border="1"> <tr> <th>Product Size</th> <th>Product Number</th> </tr> <tr> <td>2.5 US GAL (9.5 L)</td> <td>V39401</td> </tr> </table>	Product Size	Product Number	2.5 US GAL (9.5 L)	V39401	<p>BLUE CORAL® AHS HI pH 3100 (cont.) PAGE 2 OF 2</p> <p>APPLICATIONS/USE CASES/INDICATIONS:</p> <p>Recommended Dilutions:</p> <table border="1"> <tr> <th>Application</th> <th>Ratio</th> </tr> <tr> <td>General Purpose</td> <td>1:250-100</td> </tr> <tr> <td>SPR/Pneumatic</td> <td>1:100-100</td> </tr> </table> <p>TITRATION PROCEDURE:</p> <p>TITRATION PROCEDURE - ZEP COMBINATION TEST KIT (ZEP-COM-KIT000)</p> <ol style="list-style-type: none"> 1. Fill 250 mL of the 1.0N HCl with distilled water. 2. Add 2 drops of Phenolphthalein Indicator (ZEP-COM-KIT000), solution will turn purple. 3. Take 10 mL of the 1.0N HCl solution and add 10 mL of the alkaline solution to be tested. 4. As you add the solution from step 3, the color will change from purple to colorless. <p>TITRATION CHART:</p> <table border="1"> <thead> <tr> <th>RATIO</th> <th>ONE Drop</th> <th>TOTAL Drops</th> </tr> </thead> <tbody> <tr> <td>1:100</td> <td>1</td> <td>1</td> </tr> <tr> <td>1:200</td> <td>2</td> <td>2</td> </tr> <tr> <td>1:300</td> <td>3</td> <td>3</td> </tr> <tr> <td>1:400</td> <td>4</td> <td>4</td> </tr> <tr> <td>1:500</td> <td>5</td> <td>5</td> </tr> <tr> <td>1:600</td> <td>6</td> <td>6</td> </tr> <tr> <td>1:700</td> <td>7</td> <td>7</td> </tr> <tr> <td>1:800</td> <td>8</td> <td>8</td> </tr> <tr> <td>1:900</td> <td>9</td> <td>9</td> </tr> <tr> <td>1:1000</td> <td>10</td> <td>10</td> </tr> </tbody> </table> <p>HEALTH, SAFETY, STORAGE & FIRST AID INFORMATION: See Product SDS</p> <p><small>Copyright © 2019 Zep Vehicle Care Pty Ltd 1300 990 074 2115 Victoria Ave, Melbourne VIC 3021, AUSTRALIA www.velocityvehiclecare.com</small></p> <p><small>Zep Vehicle Care Pty Ltd 200 Victoria Road, Suite 100, Epping VIC 3103, USA © 2019 Zep Vehicle Care Pty Ltd</small></p>	Application	Ratio	General Purpose	1:250-100	SPR/Pneumatic	1:100-100	RATIO	ONE Drop	TOTAL Drops	1:100	1	1	1:200	2	2	1:300	3	3	1:400	4	4	1:500	5	5	1:600	6	6	1:700	7	7	1:800	8	8	1:900	9	9	1:1000	10	10
Product Size	Product Number																																											
2.5 US GAL (9.5 L)	V39401																																											
Application	Ratio																																											
General Purpose	1:250-100																																											
SPR/Pneumatic	1:100-100																																											
RATIO	ONE Drop	TOTAL Drops																																										
1:100	1	1																																										
1:200	2	2																																										
1:300	3	3																																										
1:400	4	4																																										
1:500	5	5																																										
1:600	6	6																																										
1:700	7	7																																										
1:800	8	8																																										
1:900	9	9																																										
1:1000	10	10																																										